

SNC2/3/4XX*

Exploded parts diagram

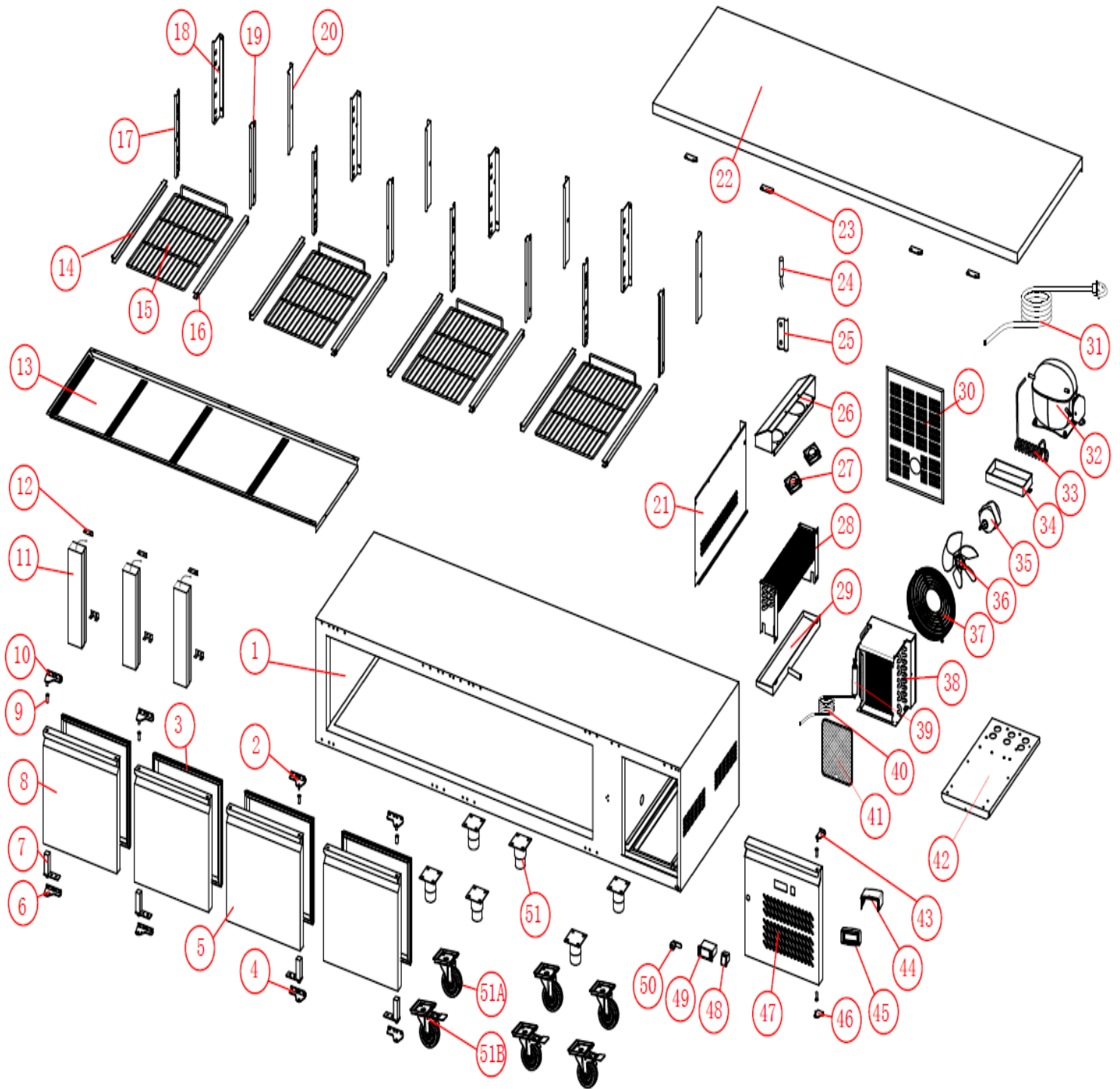





| Part Number | Number | Description | Qty |
|---------------|--------|---|-----|
| *** | 1 | Cabinet | 1 |
| X1-HINGE13 | 2 | RH Upper Hinge (SNC4XX) | 2 |
| X1-HINGE13 | 2 | RH Upper Hinge (SNC3XX) | 2 |
| X1-HINGE13 | 2 | RH Upper Hinge (SNC2XX) | 1 |
| X1-GASKET11 | 3 | Door Gasket (SNC4XX) | 4 |
| X1-GASKET11 | 3 | Door Gasket (SNC3XX) | 3 |
| X1-GASKET11 | 3 | Door Gasket (SNC2XX) | 2 |
| X1-HINGE14 | 4 | RH Bottom Hinge (SNC4XX) | 2 |
| X1-HINGE14 | 4 | RH Bottom Hinge (SNC3XX) | 2 |
| X1-HINGE14 | 4 | RH Bottom Hinge (SNC2XX) | 1 |
| *** | 5 | Door (right) (SNC4XX) *Please check cabinet Mark* | 2 |
| *** | 5 | Door (right) (SNC3XX) *Please check cabinet Mark* | 2 |
| *** | 5 | Door (right) (SNC2XX) *Please check cabinet Mark* | 1 |
| X1-HINGE15 | 6 | LH Bottom Hinge (SNC4XX) | 2 |
| X1-HINGE15 | 6 | LH Bottom Hinge (SNC3XX) | 1 |
| X1-HINGE15 | 6 | LH Bottom Hinge (SNC2XX) | 1 |
| *** | 7 | Spring Hinge (SNC4XX) | 4 |
| *** | 7 | Spring Hinge (SNC3XX) | 3 |
| *** | 7 | Spring Hinge (SNC2XX) | 2 |
| *** | 8 | Door (left) (SNC4XX) *Please check cabinet Mark* | 2 |
| *** | 8 | Door (left) (SNC3XX) *Please check cabinet Mark* | 1 |
| *** | 8 | Door (left) (SNC2XX) *Please check cabinet Mark* | 1 |
| K8-AXISSLEEVE | 9 | Door Bush (SNC4XX) | 8 |
| K8-AXISSLEEVE | 9 | Door Bush (SNC3XX) | 6 |
| K8-AXISSLEEVE | 9 | Door Bush (SNC2XX) | 4 |
| X1-HINGE16 | 10 | LH Upper Hinge (SNC4XX) | 2 |
| X1-HINGE16 | 10 | LH Upper Hinge (SNC3XX) | 2 |
| X1-HINGE16 | 10 | LH Upper Hinge (SNC2XX) | 1 |
| *** | 11 | Mullion (SNC4XX) | 3 |
| *** | 11 | Mullion (SNC3XX) | 2 |
| *** | 11 | Mullion (SNC2XX) | 1 |
| *** | 12 | Mullion Connection (SNC4XX) | 6 |
| *** | 12 | Mullion Connection (SNC3XX) | 4 |
| *** | 12 | Mullion Connection (SNC2XX) | 2 |
| *** | 13 | Air Distribution Panel | 1 |
| K8-GUIDE02 | 14 | Left Shelf Guide (SNC4XX) | 4 |
| K8-GUIDE02 | 14 | Left Shelf Guide (SNC3XX) | 3 |
| K8-GUIDE02 | 14 | Left Shelf Guide (SNC2XX) | 2 |
| X1-SHELF04 | 15 | Shelf (SNC4XX) | 4 |
| X1-SHELF04 | 15 | Shelf (SNC3XX) | 3 |
| X1-SHELF04 | 15 | Shelf (SNC2XX) | 2 |
| K8-GUIDE03 | 16 | Right Shelf Guide (SNC4XX) | 4 |
| K8-GUIDE03 | 16 | Right Shelf Guide (SNC3XX) | 3 |

| | | | |
|-----------------|-----------|--|---|
| K8-GUIDE03 | 16 | Right Shelf Guide (SNC2XX) | 2 |
| *** | 17 | Ladder Rack (left) (SNC4XX) | 4 |
| *** | 17 | Ladder Rack (left) (SNC3XX) | 3 |
| *** | 17 | Ladder Rack (left) (SNC2XX) | 2 |
| *** | 18 | Rear Ladder Rack (left) (SNC4XX) | 4 |
| *** | 18 | Rear Ladder Rack (left) (SNC3XX) | 3 |
| *** | 18 | Rear Ladder Rack (left) (SNC2XX) | 2 |
| *** | 19 | Ladder Rack (right) (SNC4XX) | 4 |
| *** | 19 | Ladder Rack (right) (SNC3XX) | 3 |
| *** | 19 | Ladder Rack (right) (SNC2XX) | 2 |
| *** | 20 | Rear Ladder Rack (right) (SNC4XX) | 4 |
| *** | 20 | Rear Ladder Rack (right) (SNC3XX) | 3 |
| *** | 20 | Rear Ladder Rack (right) (SNC2XX) | 2 |
| *** | 21 | Evap Cover (SNC4/3/2XX) | 1 |
| X1-WORKTOP4 | 22 | Counter Top no upstand (SNC4XX) | 1 |
| X1-WORKTOP3 | 22 | Counter Top no upstand (SNC3XX) | 1 |
| X1-WORKTOP2 | 22 | Counter Top no upstand (SNC2XX) | 1 |
| *** | 23 | Top Fixing Plate (SNC4XX) | 4 |
| *** | 23 | Top Fixing Plate (SNC3XX) | 4 |
| *** | 23 | Top Fixing Plate (SNC2XX) | 3 |
| K8-PROBE01 | 24 | Air Probe (SNC4/3/2XX) | 1 |
| *** | 25 | Probe Cover (SNC4/3/2XX) | 1 |
| *** | 26 | Evap Fan Cover (SNC4/3/2XX) | 1 |
| X1-FAN04 | 27 | Evap Fan (SNC4/3/2XX) | 2 |
| B1-EVAP07 | 28 | Evaporator (SNC4/3/2XX) | 1 |
| *** | 29 | Evap Drip Tray (SNC4/3/2XX) | 1 |
| *** | 30 | Back Cover (SNC4/3/2XX) | 1 |
| *** | 31 | Power Cord (SNC4/3/2XX) | 1 |
| X1-COMP05 | 32 | Compressor (SNC4XX) | 1 |
| X1-COMP06 | 32 | Compressor (SNC3/2XX) | 1 |
| *** | 33 | Vaporising Coil (SNC4/3/2XX) | 1 |
| K8-PAN01 | 34 | Vaporising Tray (SNC4/3/2XX) | 1 |
| X1-FAN01 | 35 | Cond Fan Motor (SNC4/3/2XX) | 1 |
| *** | 36 | Cond Fan Blade (SNC4/3/2XX) | 1 |
| *** | 37 | Cond Fan Guard (SNC4/3/2XX) | 1 |
| *** | 38 | Condenser (SNC4/3/2XX) | 1 |
| *** | 39 | Drier (SNC4/3/2XX) | 1 |
| X1-CAPILLARY04 | 40 | Capillary (SNC4/3/2XX) | 1 |
| *** | 41 | Condenser Filter (SNC4/3/2XX) | 1 |
| *** | 42 | Cooling Unit board (SNC4/3/2XX) | 1 |
| *** | 43 | Control Panel Upper Hinge (SNC4/3/2XX) | 1 |
| *** | 44 | plastic water-proof box (SNC4/3/2XX) | 1 |
| *** | 45 | plastic water-proof box cover (SNC4/3/2XX) | 1 |
| *** | 46 | Control Panel Bottom Hinge (SNC4/3/2XX) | 1 |
| X1-PANELSNC | 47 | Panel (SNC4/3/2XX) | 1 |
| X1-SWITCH01 | 48 | Power Switch (SNC4/3/2XX) | 1 |
| X1-CONTROLLER04 | 49 | Controller (SNC4/3/2XX) | 1 |
| X1-LOCK04 | 50 | Door Lock (SNC4/3/2XX) | 1 |
| *** | 51A & 52A | Feet (optional) (SNC4XX) | 6 |

| | | | |
|-----|-----------|-------------------------------|---|
| *** | 51A & 52A | Feet (optional) (SNC3/2XX) | 4 |
| *** | 51 | Castors (Unbraked) (SNC4XX) | 3 |
| *** | 52 | Castors (Braked) (SNC4XX) | 3 |
| *** | 51 | Castors (Unbraked) (SNC3/2XX) | 2 |
| *** | 52 | Castors (Braked) (SNC3/2XX) | 2 |

***** Please contact Spares for assistance *****

***Other model variants available;**

Drawers – SNC2-DRW, SNC3-DRW, SNC4-DRW